

SPIDER PIPE GUIDE

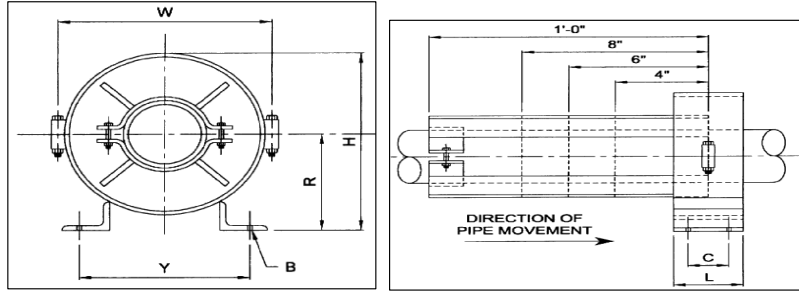

BODY NO.	(PHYSICAL DIMENSIONS(INCHES))							APPROX WEIGHT LBS.
	H	R	W	Y	B	C	L	
04	5-3/4	3-1/2	5-7/8	4-1/2	5/8	1-3/4	3	6
05	6-3/4	4	7	4-1/2	5/8	1-3/4	3	8
06	7-5/8	4-3/8	8	5-1/4	5/8	1-3/4	3	10
08	9-1/2	5-1/4	10-3/8	6-1/4	5/8	1-3/4	3	13
10	11-5/8	6-1/4	12-1/2	7-1/4	5/8	2-3/4	4	20
12	13-5/8	7-1/4	14-1/2	8-1/4	5/8	2-3/4	4	25
14	15	8	15-3/4	10	3/4	4	6	40
16	17	9	17-3/4	11	3/4	4	6	45
18	18-3/4	9-3/4	20-1/8	12	3/4	4	6	56
20	21-1/8	10-7/8	22-1/8	11-1/2	3/4	4	6	65
22	23-1/8	12-1/8	24-1/8	14-1/2	7/8	6	8	95
24	25	13	26-5/8	15-1/2	7/8	6	8	115
26	27-3/4	14-3/4	28-5/8	17-1/2	1-1/8	6	8	135
30	31-1/2	16-1/2	32-5/8	19-1/2	1-1/8	6	8	150

1) TO USE THE CHART AT THE RIGHT, YOU MUST KNOW THE PIPE SIZE, REQUIRED INSULATION THICKNESS, AND AXIAL MOVEMENT. LOCATE THE PIPE SIZE FROM THE PIPE SIZE COLUMN AND THE CORRESPONDING INSULATION THICKNESS TO FIND THE PROPPER PART NUMBER. THE LAST DIGIT(S) INDICATE(S) THE AXIAL MOVEMENT THE GUIDE CAN TRAVEL SAFLEY.

EXAMPLE: THE CORRECT PART NUMBER FOR A 4" PIPE GUIDE WITH 2" OF INSULATION AND MAX AXIAL TRAVEL OF 4" IS 040-210-4.

2) EXPLANATION OF PART NUMBER: XXX - XXX - XX
PIPE SIZE-BODY NO.-AXIAL MOVEMENT-

3) FOR GUIDES IN A COPPER SYSTEM, ADD "C" AT END OF PART NUMBER.
NOTE ADDITIONAL COST FOR SHIMS APPLY.

4) SPECIAL PIPE GUIDES NOT LISTED ARE AVAILBLEUPON REQUEST, SUCH AS PRE INSULATED, SLIDE TYPE AND OTHER CONFIGERATIONS CONTACT FACTORY FOR DETAILS.

5) USE 1" OF THICKNESS COLUM WHEN NO INSULATION IS REQUIRED.

TOTAL QTY	PIPE SIZE	1"	1-1/2"	2"	2-1/2"	3"	3-1/2"	4"
	1/2"	004-104-3 -8 -12	004-104-3 -8 -12	004-205-3 -8 -12	004-206-3 -8 -12	004-308-3 -8 -12	004-308-3 -8 -12	004-410-4 -8 -12
	3/4"	006-104-3 -8 -12	006-605-3 -8 -12	006-206-3 -8 -12	006-308-3 -8 -12	006-308-3 -8 -12	006-410-4 -8 -12	006-410-4 -8 -12
	1"	010-104-3 -8 -12	010-605-3 -8 -12	010-206-3 -8 -12	010-308-3 -8 -12	010-308-3 -8 -12	010-410-4 -8 -12	010-410-4 -8 -12
	1-1/4"	012-104-3 -8 -12	012-605-3 -8 -12	012-206-3 -8 -12	012-308-3 -8 -12	012-308-3 -8 -12	012-410-4 -8 -12	012-410-4 -8 -12
	1-1/2"	014-105-3 -8 -12	014-105-3 -8 -12	014-206-3 -8 -12	014-308-3 -8 -12	014-308-3 -8 -12	014-410-4 -8 -12	014-410-4 -8 -12
	2"	020-105-3 -8 -12	020-606-3 -8 -12	020-208-3 -8 -12	020-208-3 -8 -12	020-310-4 -8 -12	020-310-4 -8 -12	020-412-4 4 -12
	2-1/2"	024-106-3 -8 -12	024-106-3 -8 -12	024-208-3 -8 -12	024-208-3 -8 -12	024-310-4 -8 -12	024-310-4 -8 -12	024-412-4 -8 -12
	3"	030-106-3 -8 -12	030-208-3 -8 -12	030-208-3 -8 -12	030-310-4 -8 -12	030-310-4 -8 -12	030-412-4 -8 -12	030-412-4 -8 -12
	4"	040-108-3 -8 -12	040-108-3 -8 -12	040-210-4 -8 -12	040-210-4 -8 -12	040-312-4 -8 -12	040-312-4 -8 -12	040-414-6 -8 -12
	5"	050-110-4 -8 -12	050-110-4 -8 -12	050-210-4 -8 -12	050-312-4 -8 -12	050-312-4 -8 -12	050-314-6 -8 -12	050-416-6 -8 -12
	6"	060-110-4 -8 -12	060-110-4 -8 -12	060-212-4 -8 -12	060-212-4 -8 -12	060-314-6 -8 -12	060-416-6 -8 -12	060-416-6 -8 -12
	8"	080-112-4 -8 -12	080-112-4 -8 -12	080-214-6 -8 -12	080-316-6 -8 -12	080-316-6 -8 -12	080-418-6 -8 -12	080-418-6 -8 -12
	10"	100-216-6 -8 -12	100-216-6 -8 -12	100-216-6 -8 -12	100-318-6 -8 -12	100-318-6 -8 -12	100-420-6 -8 -12	100-420-6 -8 -12
	12"	120-218-6 -8 -12	120-218-6 -8 -12	120-218-6 -8 -12	120-320-6 -8 -12	120-320-6 -8 -12	120-422-6 -8 -12	120-422-6 -8 -12
	14"	140-220-6 -8 -12	140-220-6 -8 -12	140-220-6 -8 -12	140-220-6 -8 -12	140-322-6 -8 -12	140-322-6 -8 -12	140-424-6 -8 -12
	16"	160-222-6 -8 -12	160-222-6 -8 -12	160-222-6 -8 -12	160-222-6 -8 -12	160-324-6 -8 -12	160-324-6 -8 -12	160-426-6 -8 -12
	18"	180-224-6 -8 -12	180-224-6 -8 -12	180-224-6 -8 -12	180-224-6 -8 -12	180-226-6 -8 -12	180-226-6 -8 -12	180-430-6 -8 -12
	20"	200-226-6 -8 -12	200-226-6 -8 -12	200-226-6 -8 -12	200-226-6 -8 -12	200-330-6 -8 -12	200-330-6 -8 -12	200-430-6 -8 -12

CUSTOMER:	
PROJECT:	
ENGINEER:	
PO#:	